

Pitless Adapter Installation Instructions

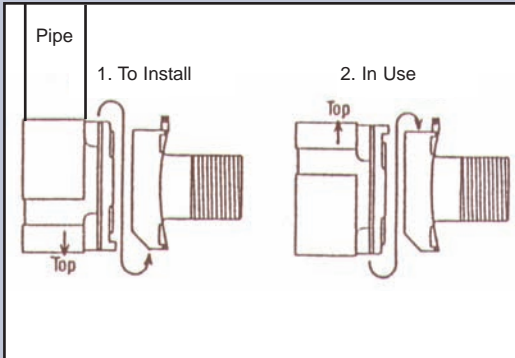
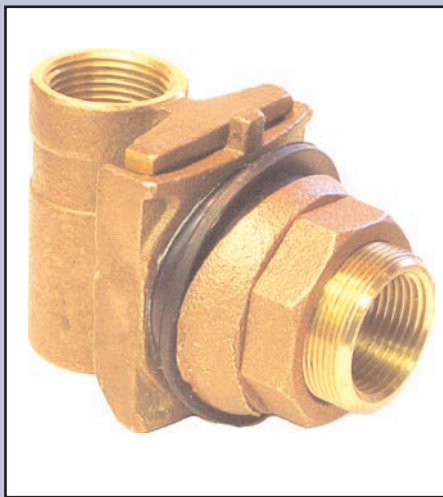

Figure 1



- Factory tested at 150 PSI
- Fits casing sizes 6" thru 12"
- Certified watertight. Passed PAS-1

NOTE:

Well Pro Pitless Adapters are designed for easier installation.

Installation Instructions

Brass Pitless Adapter

1. Pitless adapter should be installed below the frost line, and on side of well casing where the supply line will run from well.
2. Center punch at selected depth setting for pitless adapter, then cut hole in casing with the appropriate size hole saw. WMB50, WMB200, WMB100, WMB60, WMB100, WMB100N, WMBP100 all 1-3/4" hole saw. WMB225, WMB125, WMB125N, WMBP125, WMHB125 all 2-1/8" hole saw. WMB300 3" hole saw. WMHB100 1-13/16" hole saw. WMHB300 2-7/8" hole saw.
3. Remove the lock nut, backplate, and gasket. **(Do not remove female O-ring).** It should be installed inside well casing.
4. Lower female part into hole in casing by inside male part installed upside down in female (see Figure 1) with a pipe attached. The rigid pipe allows you to hold female part in the casing, while installing the gasket, backplate, and lock nut.
5. Tighten lock nut before completing installation. The back plate and lock nut should have pulled the female part and female O-ring against the inner wall of the casing. If necessary the male part and pull pipe can be used for vertical alignment while tightening lock nut.
6. Remove male part with pipe, coat machined surface and O-ring with Anti Seize/Gasket Lube. Connect male part to pump drop pipe and complete installation.

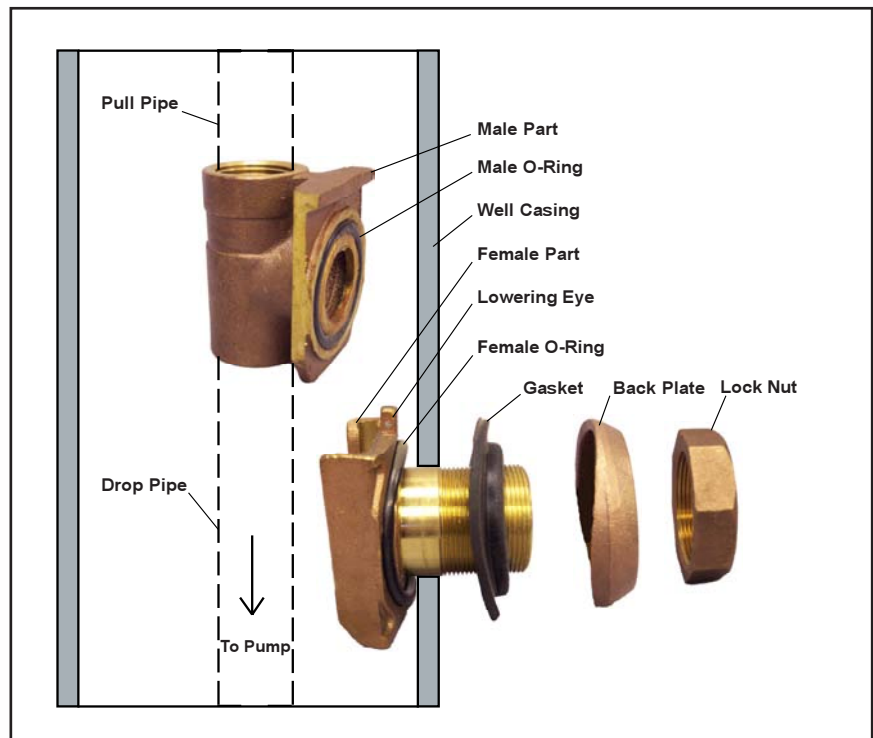

Pitless Adapter Installation Instructions



Part (A) Slide



Part (B) ELL

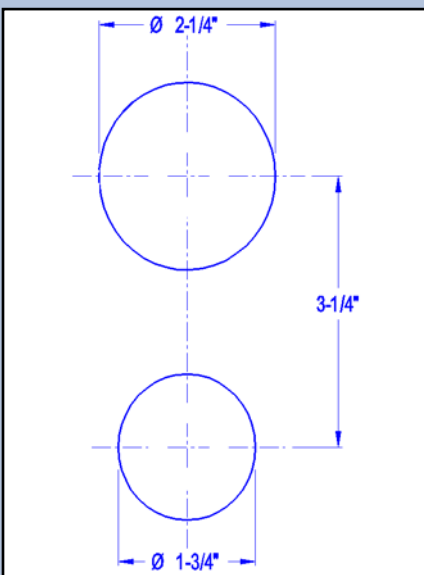

Installation Instructions for Pitless Adapter

WMHB400 Pitless Adapter

1. Locate direction pipe will run from well and scribe a true vertical line on the casing at desired location. Punch mark center of holes 3-1/4" apart. Template can be used as a guide.
2. Drill upper hole to 2-1/4" diameter and lower hole to 1-3/4" diameter. Gasket design will allow reasonable deviation from hole roundness and size. Deburr inner and outer edges of hole.
3. Lubricate machined surface of Part (A) freely with Well Pro Anti-Seize/Gasket Lube and with inner gaskets in place. Lower into casing, using small wire in hole provided, or use ELL Part (B) by sliding into Part (A) upside down with a pipe attached. Guide thru holes in casing, attach outer gaskets and washers and wrench up nuts until all gaskets are tightened and compressed against casing.
4. Part (B) can be assembled with necessary piping (lubricate O-rings and machined surfaces) lowered into casing and mated with Part (A).
5. A Well Pro Well Cap should be used to complete your installation.

NOTE: Fits all casings from 4-1/2" through 12" without changing parts.

