



W-5000 SERIES

FROST PROOF YARD HYDRANTS

Parts Kit "WPKEP" Contains

Qty.	Part Number
1	WC-35
1	WC-115
1	WA-250



Order No. WPKEP
UPC Bar Code (Qty. 1)
6 42367 08045 7

Parts Kit

"WPKEP" Contains

Qty.	Part Number
1	WC-5
1 Pair	WG-20
1	WB-25
1	WC-30
1	WC-31
1	WOR116
1	WC-35
1	WC-115

Order No. WPKEP
UPC Bar Code (Qty. 1)
6 42367 08046 4

Parts Kit

"WEFM" Contains

Qty.	Part Number
1	WC-5
1 Pair	WG-20
1	WB-25
1	WC30-ZPS
1	WC31-ZPS
1	WOR116
1	WC-35
1	WC-115

Order No. WPKEFM
UPC Bar Code (Qty. 1)
6 42367 11836 5



W-5000 Series Hydrants

Order Number	UPC Bar Code (Qty. 1)	Pipe Connection X Pipe Depth	Pipe Size	Overall Length	Approx. Wt./Lbs.
W7501	6 42367 07998 7	3/4" x 1' Bury	1" Galv.	39.5"	9.5
W75015	6 42367 07999 4	3/4" x 1-1/2' Bury	1" Galv.	45.5"	10.5
W7502	6 42367 08000 6	3/4" x 2' Bury	1" Galv.	51.5"	11.5
W7503	6 42367 08001 3	3/4" x 3' Bury	1" Galv.	63.5"	12.5
W7504	6 42367 08002 0	3/4" x 4' Bury	1" Galv.	75.5"	13.5
W7505	6 42367 08003 7	3/4" x 5' Bury	1" Galv.	87.5"	14.5
W7506	6 42367 08004 4	3/4" x 6' Bury	1" Galv.	99.5"	15.5
W7507	6 42367 08005 1	3/4" x 7' Bury	1" Galv.	111.5"	16.5
W7508	6 42367 08006 8	3/4" x 8' Bury	1" Galv.	123.5"	17.5
W7510	6 42367 10113 8	3/4" x 10' Bury	1" Galv.	147.5"	19.5

NOTE: The length of hydrant you need depends on the depth the water lines are buried in your area. If water lines are buried 4' you need the W7504 - 4' bury below ground with 28" above ground or 6' - 3-1/2' long.

WEM-5000 Series Hydrants - with metal packing gland

Order Number	UPC Bar Code (Qty. 1)	Pipe Connection X Pipe Depth	Pipe Size	Overall Length	Approx. Wt./Lbs.
WEM7501	6 42367 11808 2	3/4" x 1' Bury	1" Galv.	39.5"	9.5
WEM75015	6 42367 11816 7	3/4" x 1-1/2' Bury	1" Galv.	45.5"	10.5
WEM7502	6 42367 11809 9	3/4" x 2' Bury	1" Galv.	51.5"	11.5
WEM7503	6 42367 11810 5	3/4" x 3' Bury	1" Galv.	63.5"	12.5
WEM7504	6 42367 11811 2	3/4" x 4' Bury	1" Galv.	75.5"	13.5
WEM7505	6 42367 11812 9	3/4" x 5' Bury	1" Galv.	87.5"	14.5
WEM7506	6 42367 11813 6	3/4" x 6' Bury	1" Galv.	99.5"	15.5
WEM7507	6 42367 11814 3	3/4" x 7' Bury	1" Galv.	111.5"	16.5
WEM7508	6 42367 11815 0	3/4" x 8' Bury	1" Galv.	123.5"	17.5
WEM7510	6 42367 11818 1	3/4" x 10' Bury	1" Galv.	147.5"	19.5

W-5000/WEM-5000 Parts List

Part Number	UPC Bar Code (Qty. 1)	Part Description
WB-1	6 42367 11375 9	Head Casting
WC-5	6 42367 11376 6	Stainless Steel 1/4" Hex Head Bolt
WG-6	6 42367 11370 4	Hose Thread Adapter
WP-10	6 42367 09403 4	Lever Casting
WP-15	6 42367 11362 9	Lever Bolt & Nut
WG-20	6 42367 11363 6	Draw Straps (Per Pair)
WB-25	6 42367 11377 3	Pivot Connector
WC-30	6 42367 11378 0	Packing Nut
WC-31	6 42367 11379 7	Packing Gland
WC30-ZPS	6 42367 11833 4	Metal Packing Nut
WC31-ZPS	6 42367 11834 1	Metal Packing Gland
WC-35	6 42367 11382 7	Valve Stem Packing
WOR116	6 42367 11381 0	O-Ring Seal
WC-40T	6 42367 11383 4	Valve Body
C-57		5/16" Operating Rod
C-60		1" Galvanized Pipe
WC-115	6 42367 10895 3	Plunger
A-250	6 42367 07720 4	Container of Silicone Lube
WB-121	6 42367 10917 2	Head Assembly Parts No. WB-1, 25, WC-5, 30, 31, 35, WG-6, 20, WOR116, WP-10 & 15
WC-131	6 42367 11380 3	Packing Gland Assembly WC-30, 31, 35, WOR116
WC131-ZPS	6 42367 11835 8	Packing Gland Assembly WC30-ZPS, WC31-ZPS, WC-35, WOR116

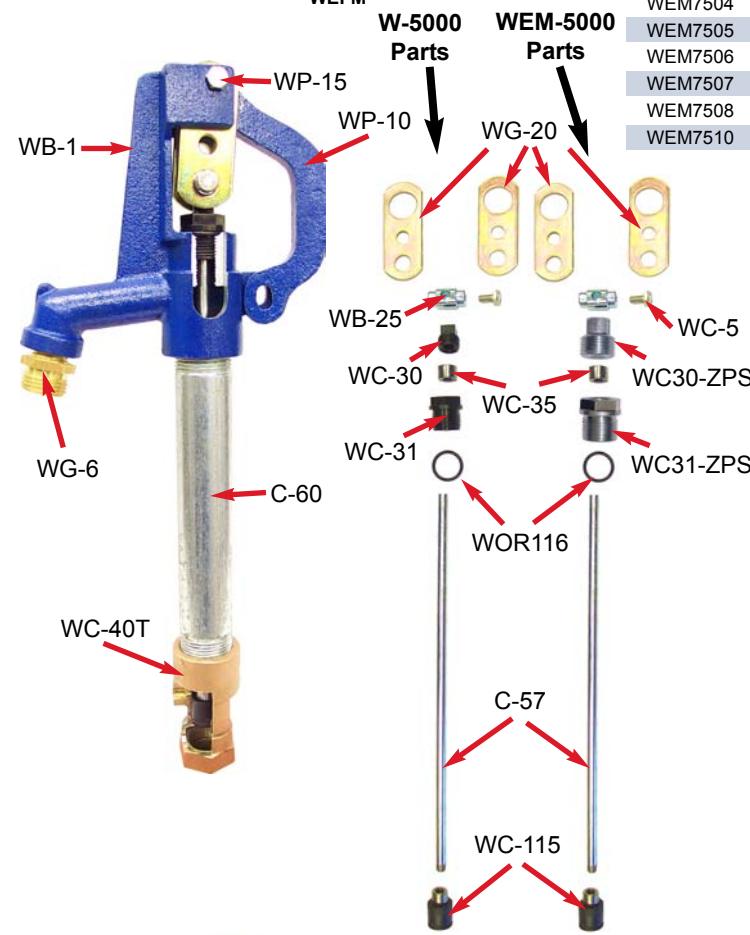

The Water Well Products used by PROFESSIONALS

"The Best of Both Worlds - Quality and Price"



CONTACT INFO:

Main/International:(712) 732-7354
U.S. and Iowa:(877) 888-7059
Fax:(712) 732-7568
Fax:(800) 269-3569

Quality Features

The W-5000 Series Yard Hydrant gives year 'round water service that drains below the frost line when shut off.

Hydrants available with optional Red Brass Hydrant Ells and Tees.

Include number (i.e. WRBHE75) after Order No.

WRBHE75	3/4" NPT x 3/4" Plastic Pipe Elbow
WRBHE100	3/4" NPT x 1" Plastic Pipe Elbow
WRBHT75	3/4" NPT x 3/4" Plastic Pipe Tee
WRBHT7510	3/4" NPT x 1" Plastic Pipe Tee



Hydrants available with optional Brass Vacuum Breakers

ASSE-IAPMO Code approved and marked

WBVBAD75	3/4" Hose - Brass Finish AUTOMATIC DRAIN
WBVB75M	3/4" Hose - Brass Finish MANUAL DRAIN
WBVB75P	3/4" Hose - Chrome Plated MANUAL DRAIN



WBVBAD75 WBVB75M WBVB75P

Specifications

Inlet: 3/4" NPT in Brass Casting

Outlet: 3/4" Brass Hose Thread

Graphite Packing

Brass and Molded Rubber Plunger

Made of Self-Lubricating Material

1" Galvanized Pipe

W-5000 Flow Rates

WATER SYSTEM PRESSURE	GALLONS PER MINUTE (GPM)										
	0	5	10	15	20	25	30	35	40	45	50
20 PSI	15.4 GPM @ 20 PSI										
30 PSI	18 GPM @ 30 PSI										
40 PSI	22 GPM @ 40 PSI										
60 PSI	27 GPM @ 60 PSI										
80 PSI	32 GPM @ 80 PSI										
100 PSI	36 GPM @ 100 PSI										

NOTE: Most common 1/2 hp submersible pump output is 10 GPM.

Features and Benefits

Since 1993

- A** **Lever Control*** operates by cam principle and pulls straight up on operating rod. Provides variable flow from trickle to full flow without lock to hold lever.
Benefit - Variable flow with no lock that rusts in place.
- B** **Draw Straps** are made of 1040 hot rolled steel which is much harder (Brinell 175/200) and stronger. Greatly reduces wear of straps and eliminates side pull on operating rod.
Benefit - Longest operating life.
- C** **Operating Rod** has smooth galvanized surface to maximize packing life.
Benefit - Longer service life of seal around rod.
- D** **Heavy-Duty Solid Brass Hose Adapter** threaded for standard 3/4" hose coupling.
Benefit - Standard hose fitting, readily available.
- E** **Heavy Cast Iron Head** with the same time-proven design Well Pro has used for over fifty years.
Benefit - Time-proven design takes years of abuse.
- F** **Pivot Connector*** a 1/4" hex head bolt provides simple positive adjustment and eliminates unreliable set screws used by other companies.
Benefit - Adjustable for years, not like rusting set screws.
- G** **Tough Packing Gland** for easy plunger replacement.
Benefit - Less time for plunger replacement.
Option: Metal packing gland available in WEM-Series.
- H** **Galvanized Pipe** has no exposed threads subject to the weather.
Benefit - No exposed steel on pipe to rust.
- I** **One Piece Plunger** uses double seal design to assure positive shut-off even when foreign particles are present. Plunger positively opens drain to prevent freezing, and positively closes drain even at slow flow rates.
Benefit - Economical design that still closes drain hole.
- J** **Long Life Plunger*** is molded with ethylene propylene material that is self-lubricating and will not bond to brass valve body like rubber plunger used by other companies.
Benefit - Longest operating life in one piece design.
- K** **Double Bypass Valve Body** provides a large volume of water and a patented Well Pro design.
Benefit - High water flow with economical design.
- L** **Locking Eye** on head and lever allows hydrant to be padlocked shut when not in use.
Benefit - Protects from wasting of water.
- M** **Simplest Hydrant To Service** no need to dig up hydrant to inspect plunger. Shut off water supply. Remove lever handle, loosen packing gland in head casting and pull up rod with plunger, or simply unscrew head and pull out rod and plunger.
Benefit - Very simple repair, easily done at ground level.

* Exclusive WELL PRO Quality Features

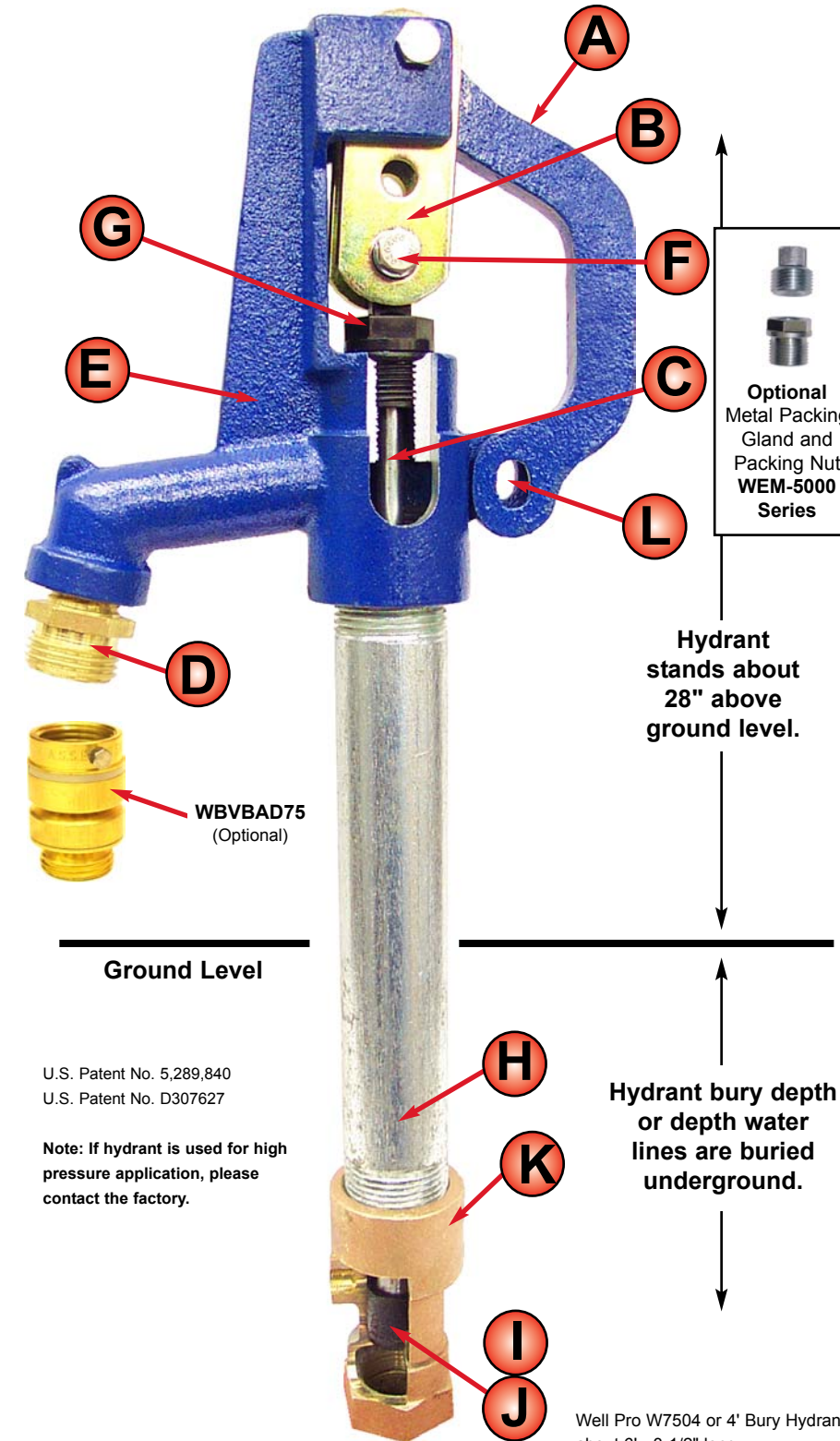

Well Pro W7504 or 4" Bury Hydrant is about 6' - 3-1/2" long. 4' is buried and 28" is above ground.

- A** Lever Control*
- B** Draw Straps
- C** Operating Rod
- D** Heavy Duty Solid Brass Hose Adapter
- E** Heavy Cast Iron Head
- F** Pivot Connector with Stainless Steel Bolt*
- G** Packing Gland - Plastic or Optional Metal Packing Gland
- H** Galvanized Pipe
- I** One Piece Plunger
- J** Long Life Plunger*
- K** Double Bypass Valve Body
- L** Locking Eye
- M** Simplest Hydrant To Service*

* Exclusive WELL PRO Quality Features

W-5000
SERIES



W-5000
SERIES